

112.4371M.

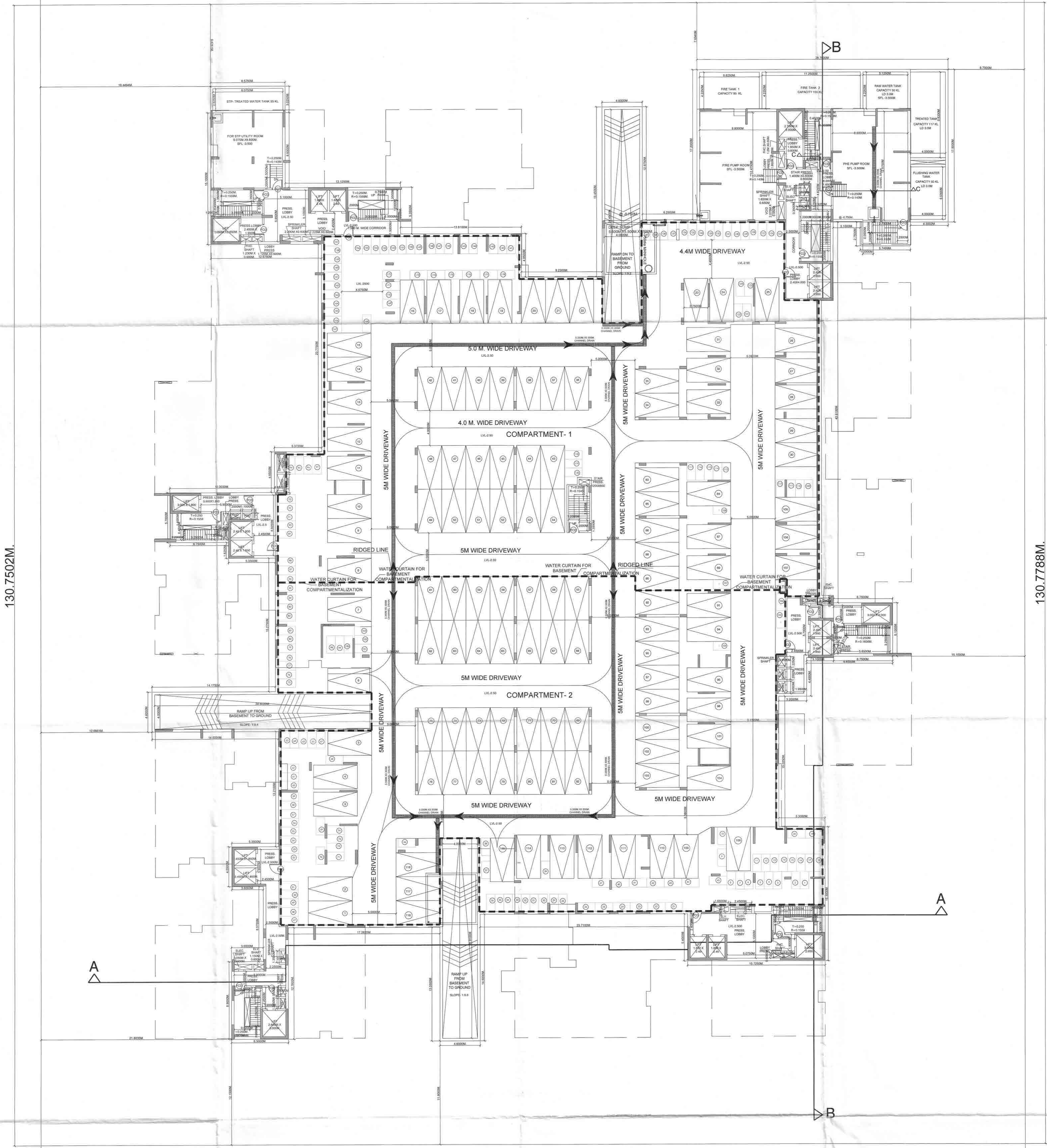

112.4684M.

BASEMENT PLAN WITH SITE

DOORS				WINDOWS			
MKD.	WIDTH	HEIGHT	REMARKS	MKD.	WIDTH	HEIGHT	SILL
D	1500	245	DOUBLE PANEL	W	2800	2000	300
D1	1200	2300	SINGLE PANEL	W1	1800	2000	300
D2	1000	2300	SINGLE PANEL	W2	1500	2000	300
D3	900	2300	SINGLE PANEL	W3	750	2000	300
D4	750	2300	SINGLE PANEL	W4	600	1100	1200
SD1	2800	2300	SLIDING DOOR	W5	900	1100	1200
SD2	1500	2300	SLIDING DOOR	W6	1000	1100	1200
FCD	1200	2300	SINGLE PANEL	SW	1000	1700	750
				V	450	450	2600
				V1	450	450	3350

PROJECT TITLE:

PROPOSED (B+G+13) STORIED RESIDENTIAL BUILDING COMPRISING OF SIX Nos. of WINGS WITH A COMMON BASEMENT AND CONNECTED THROUGH PODIUM AT 1ST FLOOR LEVEL AT PLOT NO.-: HIG-1 AT UTSODHAARA : TEESTA TOWNSHIP AT MOUZA DABGRAM, J.L. NO.2, BLOCK RAJGANJ, DISTRICT : JALPAIGURI, P.O.-: SATELLITE TOWNSHIP, P.S.-: NEW JALPAIGURI, PIN CODE:- 734 015, WEST BENGAL.

NOTES:

- ALL DIMENSIONS ARE IN MM. UNLESS OTHERWISE MENTIONED.
- ALL EXTERNAL WALL ARE 200 THK & ALL INTERNAL WALLS ARE 125 THK IN 1:4 CEMENT SAND MORTAR IF NOT STATED OTHERWISE.
- ALL CHAJJAS ARE 150 THK & 500 MM. PROJECTED.
- DEPTH OF UNDERGROUND WATER RESERVOIR SHOULD NOT EXCEED THE DEPTH OF FOUNDATION.
- GRADE OF CONCRETE & GRADE OF STEEL USED ARE M25 & Fe 500 RESPECTIVELY.
- RCC FRAMED STRUCTURE.
- ANY DISCREPANCY IN SCALE, THE WRITTEN DIMENSION SHALL GOVERN.
- FOR SPECIFICATION OF MATERIALS & WORKMANSHIP N.B.C 1984 TO BE FOLLOWED.
- OPEN TERRACE WITH LIME TERRACING OF RATIO 2:2:7.
- DAMP PROOF COURSE TO BE PROVIDED WITH P.C.C (1:2:4).
- ALL STRUCTURAL DETAILS WILL BE PROVIDED AS PER STRUCTURAL CALCULATION SHEET WITH DETAIL DRAWING SUBMITTED STRUCTURAL ENGINEER ATTACHED WITH THIS PLAN.
- THE STRUCTURAL DRAWING SHOWN IN THIS DRAWING IS INDICATIVE ONLY. THE DETAILS WILL BE DONE AS PER THE STRUCTURAL CALCULATIONS GIVEN BY THE STRUCTURAL CONSULTANT.
- THIS BUILDING CONSISTS OF 16 NO. LIFTS.
- NATURAL VENTILATION & LIGHTING FOR LIVING/DINING & KITCHEN AREA WILL BE CATERED THROUGH BALCONY & UTILITY AREA RESPECTIVELY. ADEQUATE MECHANICAL VENTILATION AS PER RULE WILL BE PROVIDED, WHERE NATURAL VENTILATION IS NOT AVAILABLE.
- AUTOMATIC SPRINKLER SYSTEM SHALL BE INSTALLED IN THE BASEMENT AND GROUND FLOOR OF THE BUILDING AS PER FIRE SAFETY RECOMMENDATION VIDE MEMO NO. FSR/0125186227900238, DATED:- 03.08.2022.
- INTERNAL DRIVEWAY IS CAPABLE TO CARRY 45 MT VEHICULAR LOAD.
- RAMPS AT BASEMENT WILL BE CONSIDERED AS EXIT AS PER CLAUSE NO. 4.4.2 & TABLE-5 (NOTE-2) OF NBC-2016 (VOL-I, PART-IV).
- SOLAR ENERGY UTILIZATION WILL BE PROVIDED THROUGH SOLAR PANELS AT ROOF LEVEL @ 5% OF CONNECTED LOAD AS PER CLAUSE NO. 21.2.1 OF NBC-2016 (VOL-I, PART-III). IT WILL BE USED IN COMMON SERVICES OF THE PROJECT.

DECLARATION OF OWNER

DECLARE THAT I SHALL NOT ALTER OR MAKE ANY ADDITION OR ALTERATION TO THIS PLAN. DECLARE THAT I HAVE GONE THROUGH THE RULES AND REGULATIONS OF THE RELEVANT AUTHORITY AND ALSO UNDERTAKE TO ABIDE BY THOSE RULES AND REGULATIONS DURING AND AFTER THE CONSTRUCTION OF THE BUILDING. I MAY APPOINT A LBS/TECHNICAL PERSON FOR SUPERVISION DURING CONSTRUCTION.

Signature of Owner
 SIGNATURE OF OWNER
 AMBUJA NEOTIA TEESTA DEVELOPMENT PVT. LTD.

DECLARATION OF STRUCTURAL ENGINEER

THE STRUCTURAL DESIGN & DRAWINGS OF BOTH FOUNDATION & SUPERSTRUCTURE OF THE BUILDING HAS BEEN MADE BY CONSIDERING ALL POSSIBLE LOADS INCLUDING THE SEISMIC LOAD AS PER NATIONAL BUILDING CODE & CERTIFIED THAT IT IS SAFE & STABLE IN ALL RESPECT. MOREOVER I SHALL BE HELD RESPONSIBLE FOR ANY STRUCTURE DAMAGE OR FAILURE IF HAPPENED DURING CONSTRUCTION PERIOD & THEREAFTER BEYOND THE DATE OF TAKING COMPLETION CERTIFICATE.

Signature of Structural Engineer
 SIGNATURE OF STRUCTURAL ENGINEER
 UTPAL SANTRA (MCC-ESE/185)

DECLARATION OF ARCHITECT

CERTIFIED THAT THE PLAN HAS BEEN DESIGNED AND DRAWN UP STRICTLY ACCORDING TO THE NATIONAL BUILDING CODE (NBC) 2016 AND RELEVANT AUTHORITY AND I SHALL BE RESPONSIBLE FOR THE SUPERVISION OF THE BUILDING.

Signature of Architect
 SIGNATURE OF ARCHITECT
 KAMAL KUMAR PERIWAL (CA-95/18579)

TITLE: **BASEMENT FLOOR PLAN WITH SITE**

ARCHITECTS: MAHESHWARI & ASSOCIATES, 37A, BAKER ROAD, 2ND FLOOR ALIPUR, KOLKATA - 700 027 www.architects.com

SCALE: 1:100 DATE: 15.11.2022 DEALT: CHECKED:

DRG. NO. MA/UTSODHARA/HIG-1/SAN/ARCH/02

2

Construction of the Building shall be supervised by the Licensed Building Surveyor / Architect signing the Plan.
Application unless otherwise approved by the Authority the permission shall remain valid for period of ONE YEAR.
Registration no. B02251474/15/2012
Permission granted / Permission granted subject to the condition as noted in the order. Building Plans also to be approved by the Corporation/Municipality Town Planner.
I/DE ORDER NO. 2022
DATE: 15/08/2022
For Signant Japagun Development Authority
SILVIA P.